

Tips and Tricks

- Conserve your battery by not burning your Sola 4000 at full brightness. Your Sola 4000 has a D-ring on the bottom for attaching a lanyard; it is recommended to tether the light to your housing in case it comes loose.
- When using the 3/4" Loc-line arms, position the light by grasping the 3/4" Locline base. This minimizes any risk of accidentally popping the light off of the arm.

Standard Warranty

Light & Motion provides a limited warranty to the original purchaser of its products against all defects in original workmanship and material, under normal use and service, for two years from the date of purchase with the following exceptions:

- Batteries are warranted for 90 days • Cosmetic discoloration of surfaces

Light & Motion will not be liable for any further loss, damages, or expenses, including incidental or consequential damages directly or indirectly arising from the sale or use of this product. Products not manufactured by Light & Motion are not covered under the Light & Motion warranty. These products are covered by the Terms and Conditions set forth by their respective manufacturers.

Important Information:

- Always store your light fully charged • Always lock the control switch when traveling or in storage • Never leave your equipment in the rinse bucket. It may be damaged by other equipment • Rinse equipment in fresh water after every dive.

Light & Motion
300 Cannery Row
Monterey, CA 93940
831-645-1525
lightandmotion.com

Indicator Lights

The indicator lights are located on the rear of the light.

Battery Status

The Battery Status LED is located at the bottom of the display window. The color of the LED represents the amount of battery power:

Green:	100% - 75%
Amber:	75% - 50%
Red:	50% - 25%
Flashing Red:	25% - 0%

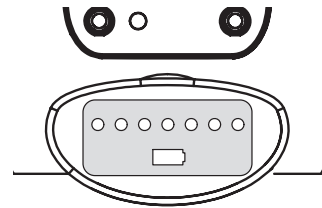

When the LED plate is installed, the Battery Status LED will be lit whenever the Mode Switch is set to Dive mode, unless the light has experienced a Low Power Shutdown.

Charging Status

When the light is charging, the Light Output Status LEDs will blink from left to right. The Battery Status LED will change colors from red to green to reflect its charge status.

Flashing Red:	0% - 50%
Flashing Amber:	50 - 75%
Flashing Green:	75% - 99%
Green:	100%

Low Power Shutdown

When the battery is drained, the Battery Status LED will flash red for five seconds, and the light will turn off entirely.

PLEASE NOTE: After a low power shutdown, the light cannot be turned back on until charged.

Light Output Status

The Light Output Status LEDs are seven LEDs located above the Battery Status LED. They indicate the Sola 4000's brightness level as follows:

1 LED =	500 Lumens
2 LEDs =	750 Lumens
3 LEDs =	1000 Lumens
4 LEDs =	1500 Lumens
5 LEDs =	2000 Lumens
6 LEDs =	3000 Lumens
7 LEDs =	4000 Lumens

SOS Mode

When the light is in SOS Mode, the Light Output Status LEDs will flash SOS in time with the light, and the Battery Status LED will turn off.

Leak Detector

If the Sola 4000 detects a leak, the light will turn itself off, and the Light Output Status LEDs will flash in a left-to-right-to-left pattern. Do not try to charge the light if a leak is indicated.

To turn off the flashing Light Output Status LEDs, hold the On/Off switch forward or backward for 2 seconds.

If a leak is detected, the Sola 4000 will not turn on and must be returned to the factory for service.

<http://www.uwimaging.com/support>

LIGHT & MOTION

SOLA[®] 4000 Manual

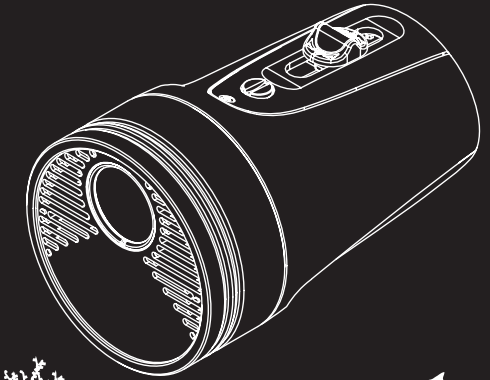

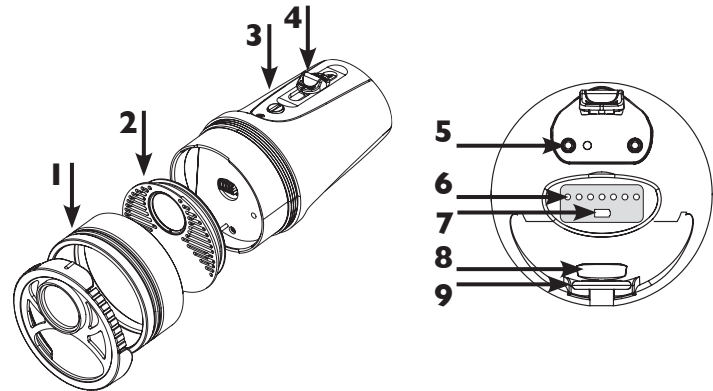

Sola Exploded view:

- | | |
|----------------------------|---------------------------------|
| 1. Bezel | 5. Charge pins |
| 2. LED Plate | 6. Brightness indicator display |
| 3. Dive/Travel Mode Switch | 7. Battery status LED |
| 4. Slider Switch | 8. D-ring |
| | 9. Mount plate |

Step 1:

Caution Caution Caution!

Please read this manual carefully: the Sola 4000 is a professional underwater video light which can produce high levels of light and heat, and must be used with care.

- Do not turn your Sola 4000 on outside of the water for more than a few seconds at a time. It is designed to be cooled by surrounding water, and may overheat if it is not adequately cooled.
- Never look directly at the Sola 4000's LEDs when turned on.
- The Sola 4000 has a hard off switch or Mode Switch that completely disconnects the battery from the circuit for travel. In addition the LED plate can be removed if required by airport security.

Step 2:

First-Time Assembly/Travel Safety Features

Your Sola 4000 will ship to you with the LED plate turned backwards, and the Mode Switch set to "Travel" (the airplane icon). This is the recommended method of travel with your Sola 4000 to comply with the strictest aviation regulations.

Connecting the LED plate

1. Unscrew the silver threaded bezel and remove the LED plate.
2. Check the o-ring and sealing surfaces of your Sola Nightsea LED plate for any debris and be sure there is a light coating of silicone grease on the o-ring.
3. Flip the LED plate and position it so the pin on the body mates with the hole on the back of the LED plate.
4. Press the LED plate into place, and screw the bezel back on securely.

Dive/Travel mode

The Dive/Travel mode switch physically disconnects the Li-Ion battery from the circuit. To connect the battery, turn the dial so that the groove points at the scuba diver icon. The light will be ready for use but will remain off.

Slider Switch

The Slider Switch activates the light, and controls brightness. It can also be locked into place to by centering the slider and rotating the switch 90 degrees in either direction.

Step 3:

Charging the Sola 4000

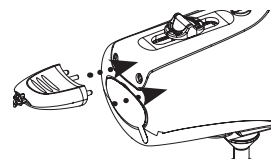

Note: The Sola 4000 will not charge unless the LED plate is connected.

To charge: Turn the Mode Switch to Dive mode and connect the charger to the back of the light head. The rear display LEDs will light up left to right to confirm the light is charging and the battery icon will indicate the charge level.

Step 4:

Operation

Turn the Mode Switch to Dive. Unlock the Slider Switch, and tap it forward or back. The light will turn on in the level 4 position (1500 lumens). Do not leave the light on for more than a few seconds in air.

- Tapping the switch forward while the light is on will increase the brightness level until it reaches the highest setting (power level 7).
- Tapping the switch backward will decrease the brightness level until it reaches the lowest power setting (power level 1).
- Holding the switch in the forward or backward position for two seconds will turn the light off.

SOS Mode

- From off: hold the Slider Switch back. The light will come on as usual, but continue holding for four seconds and SOS Mode will be activated. Release Slider.
- From on: hold the Slider Switch back. At first, the light will turn off, but after 3 more seconds, it will come back on in SOS mode.

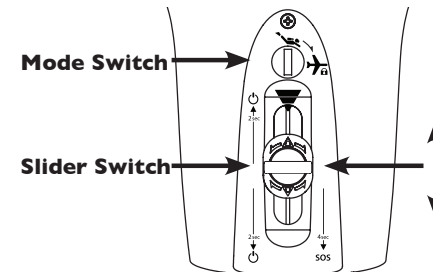

- Turn off SOS mode by holding the Slider Switch back for 4 more seconds.
- To change from SOS to On, tap the Slider Switch forward.

Accessories and Extras

To buy accessories, contact your Light & Motion dealer with the product part numbers below.

Cyan Filter Wheel - (800-0162)

The Cyan filter matches the Sola 4000's light to the color of the ambient sunlight. This allows you to shoot images using the same red filter on your camera lens as you would use to shoot in the ambient light, making it possible to shoot scenes with the foreground and background matching in color. The filter screws into the filter wheel using a standard 37mm filter thread, making it easy for you to insert your own custom filters.

Sola 4000 Video Arm Kit - (802-0272)

This kit allows you to mount the Sola 4000 to any Light & Motion Bluefin or Stingray housing equipped with a quick-release base. It requires replacement of the 1" photo ball mount with the 3/4" Locline mount (included in this kit). Buy this kit if you don't have arms to mount the Sola 4000 to your Light & Motion housing. This kit is included in all Sola 4000 Travel Packages.

Sola 4000 Video Mount Kit - (800-0166)

This kit consists of ONLY the 3/4" Locline mount for the Sola 4000. Buy this kit if you already own 3/4" Locline arms.

YS Mount- (800-0188)